

# SEMBOX

## Let&Go



ECO 10  
Smart Key

### Why to choose SEMBOX ?

- SEMBOX Protects your valuables.
- SEMBOX is designed for several usages; it could be used as a table under the sunshades or use it singly as a bistro.
- SEMBOX has a rotatable form.
- SEMBOX gives you the advantage of advertising!
- Set your Company Logo, Brand or any Visual on it.

### Physical Specifications

#### Dimensions

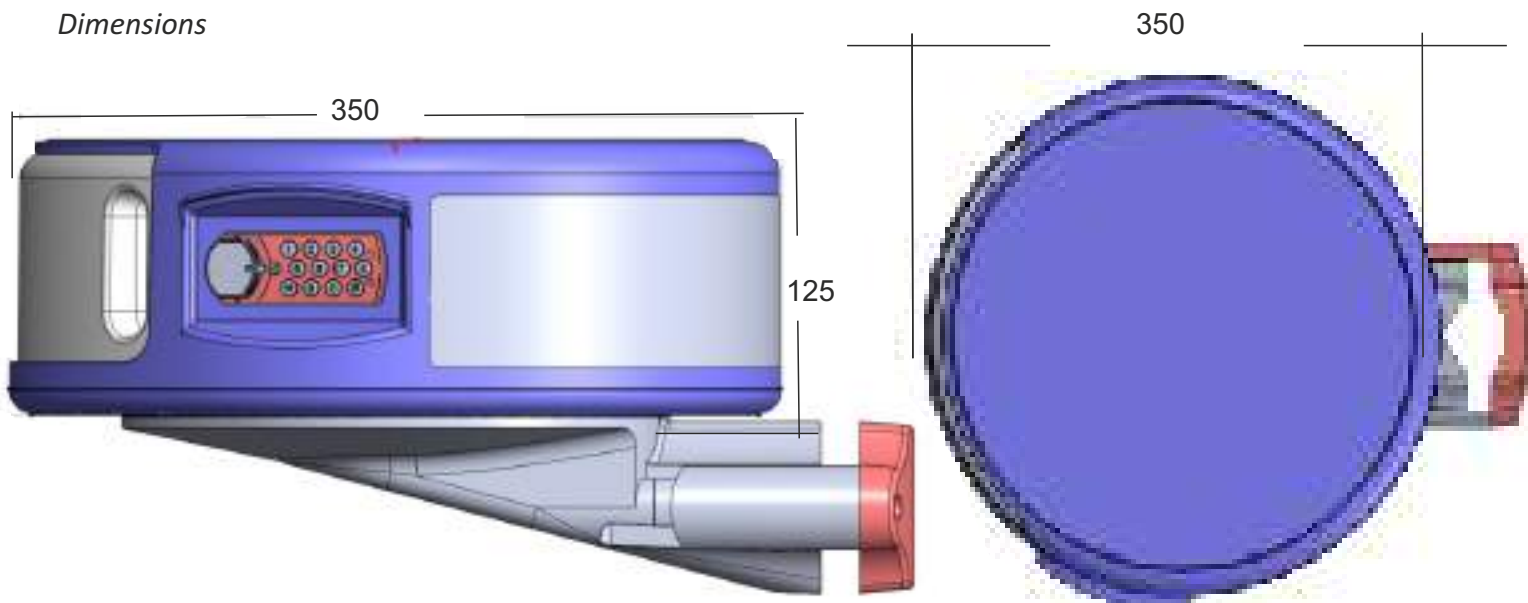

Net gross weight 2050 Gr



*Technical Specifications*

Net gross weight	2050 Gr
Storage capacity	11.5 Lt
Connection to pillar	From $\phi$ 25 mm to $\phi$ 100 mm

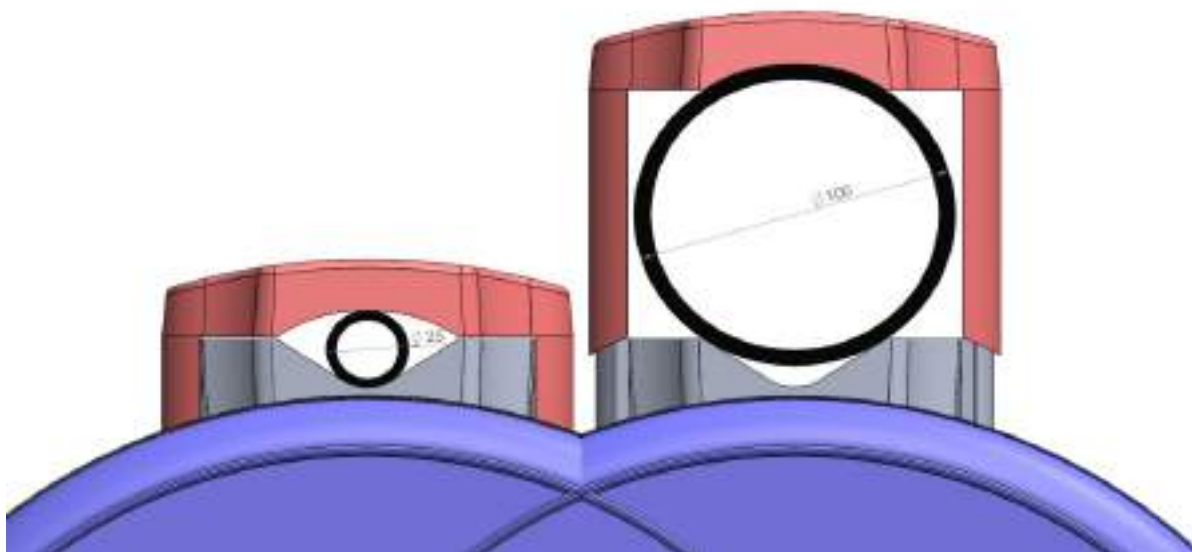

Sembox is rotatable to the right and left side for more practical use .

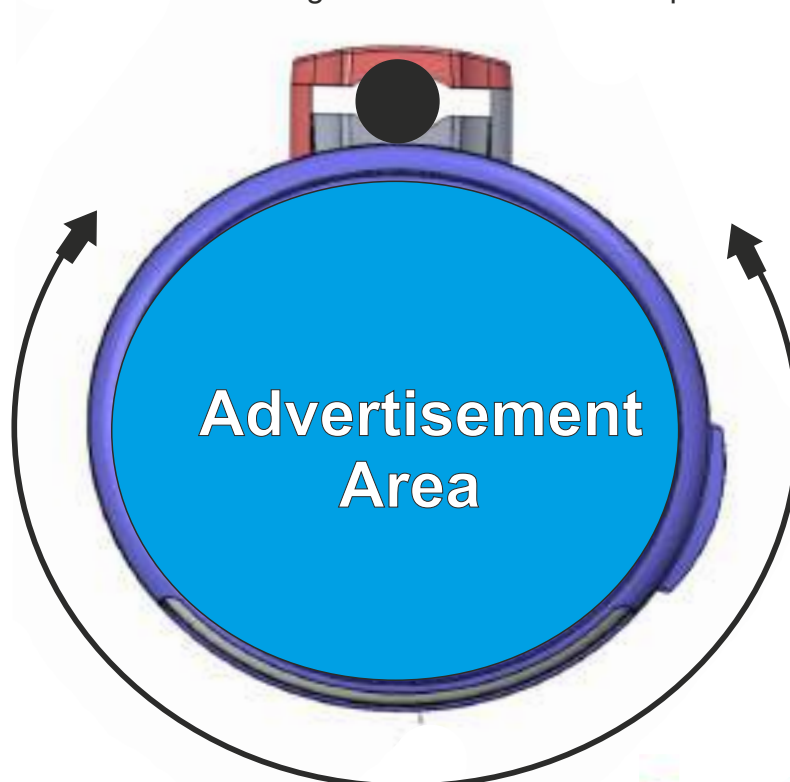

## Structure Specifications

Injected by engineering plastics with UV protection

ABS HF/UV

The structure won't be effected neither by Sun ,sea,sand or sea salt.

# ABS HF380U

Injection Molding

Properties	Test Condition	Test Method	Unit	Typical Value
<b>Physical</b>				
Specific Gravity		ASTM D792	-	1.04
Molding Shrinkage (Flow), 3.2mm		ASTM D955	%	0.4~0.7
Melt Flow Rate	220℃/10kg	ASTM D1238	g/10min	43
<b>Mechanical</b>				
Tensile Strength, 3.2mm @ Yield	50mm/min	ASTM D638	kg/cm <sup>2</sup>	450
Tensile Elongation, 3.2mm @ Break	50mm/min	ASTM D638	%	40
Tensile Modulus, 3.2mm	1mm/min	ASTM D638	kg/cm <sup>2</sup>	21,900
Flexural Strength, 3.2mm	15mm/min	ASTM D790	kg/cm <sup>2</sup>	720
Flexural Modulus, 3.2mm	15mm/min	ASTM D790	kg/cm <sup>2</sup>	24,500
IZOD Impact Strength, 6.4mm (Notched)	23℃	ASTM D256	kg-cm/cm	25
	-30℃		kg-cm/cm	12
IZOD Impact Strength, 3.2mm (Notched)	23℃	ASTM D256	kg-cm/cm	27
	-30℃		kg-cm/cm	12
Rockwell Hardness	R-Scale	ASTM D785	-	106
<b>Thermal</b>				
Heat Deflection Temperature, 6.4mm (Unannealed)	18.6kg	ASTM D648	℃	86
	4.6kg		℃	89
Vicat Softening Temperature	5kg, 50℃/h	ASTM D1525	℃	94
Flammability		UL94		HB
Relative Temperature Index		UL 746B		
Electrical			℃	60
Mechanical with Impact			℃	60
Mechanical without Impact			℃	60

SEM<sup>®</sup>BOX

Let&Go



# Technical properties of digital keypad ECO 10,

- \* 10 year of battery life.
- \* Easy applications .
- \* Multiple user or single use

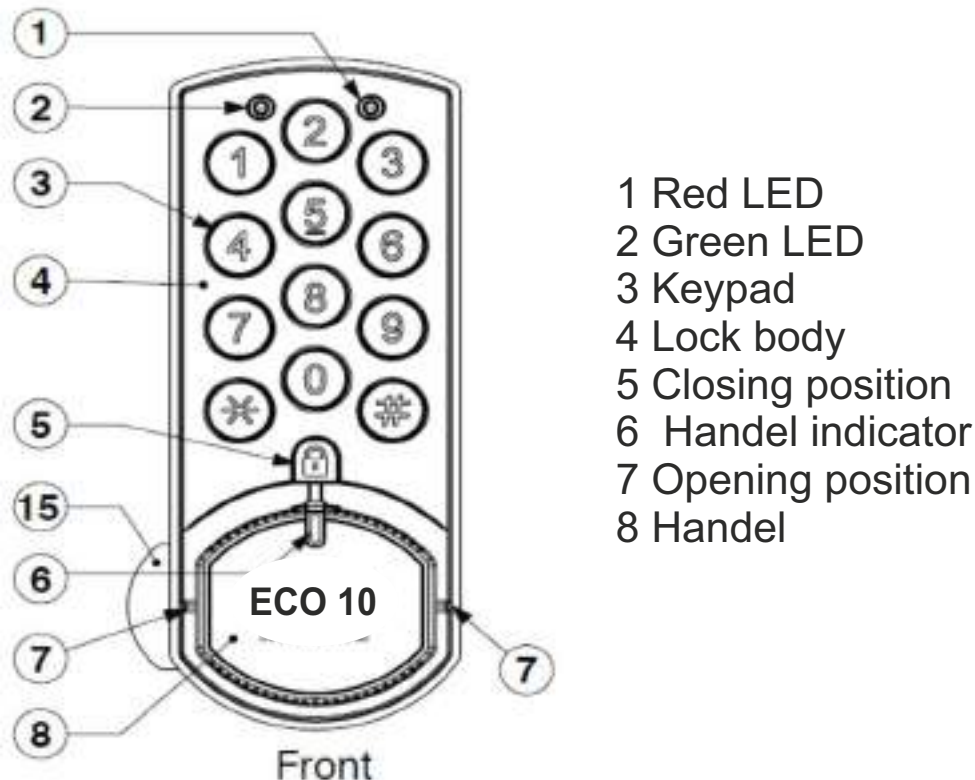

Eco10 electronic cabinet lock with master/manager code, one-time-use functionality, and up to 10 years battery life.

## PASSWORD LEVELS:

The Eco10 has two potential password levels .

1. User password
2. Master password

## MULTIPLE USER MODE (LOCKER MODE / ONE-TIME-USE MODE)

Each time lock is in open position, each user enters in their own unique 4-digit code to lock and then use that same code to again open the Eco10.



**NOTE:** Lock is open, first user enters in <3-4-2-8> and closes lock. They return and enter the same <3-4-2-8> to open the lock. Lock is open, next user enters in their code of <7-8-5-2>, closes lock and so on.



## NOTE: WHAT HAPPENS IF USER FORGETS THEIR PASSWORD?

### Locker Mode (Multiple User):

Use Master code to unlock and turn handle to open position. Lock is now ready for next user to enter in their unique code.

**MASTER PASSWORD:** Opens lock and grants access to all programming features.

**OPENING WITH MASTER PASSWORD:** Default - <1-0-1-0-1-0>

- 1) Press **#** the button and enter current 6-digit master password and press **#** button.
- 2) Rotate handle within 5 seconds to opening direction. You will get a confirmation from lock green LED light will blink.



### CHANGING MASTER PASSWORD:

Set new master password and test BEFORE installing lock.

Press **#** button twice, and then enter old 6-digit master password. Press **#** button again and enter new 6-digit master password. Press **#** button again and approve new password. You will get a confirmation beep from lock.

